

**NEW**

# BestCare<sup>®</sup>

By Whitehall Manufacturing<sup>®</sup>

## ADA LIGATURE-RESISTANT HANDHELD SHOWER AND COLLAPSIBLE SHOWER MOUNTING BRACKET

DESIGNED FOR  
QUICK ATTACHMENT  
& EASY REMOVAL

PROTECT YOUR  
PATIENTS WHERE RISK  
IS A CONCERN.

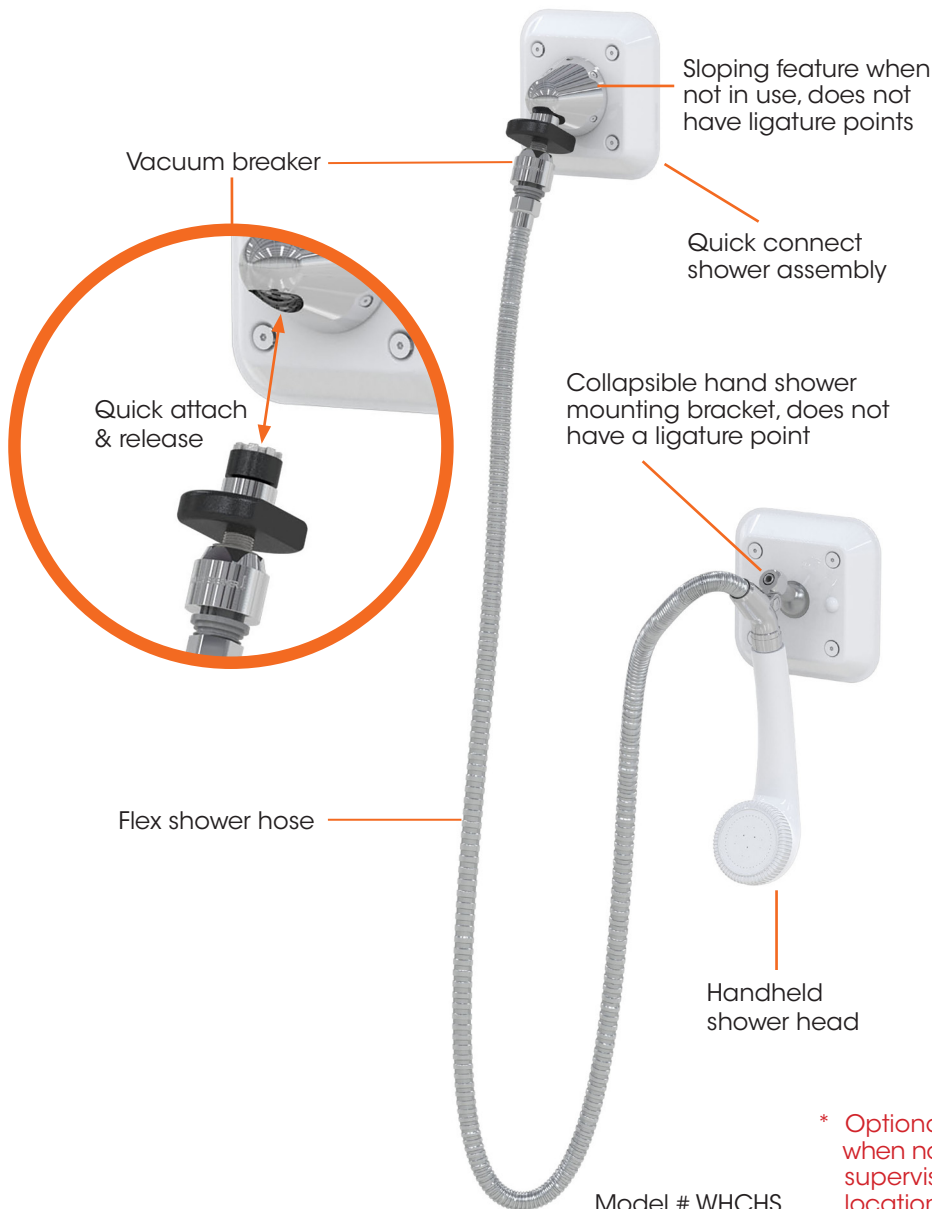

- Comes complete as a package with ligature-resistant collapsible handheld shower mounting bracket and adapter base
- 1.5 GPM handheld shower with on/off pushbutton
- Solid brass and stainless steel construction with White Enviro-Glaze<sup>®</sup> powder coat, stainless steel and polished chrome plated finishes
- ADA and CBC (California building code) 1115B.4.4.5 compliant when mounted at a maximum of 48" above floor



ADA ACCESSIBLE



AFFORDABLE



QUICK INSTALLATION

Model # WHCHS

\* Optional access box available for containment of hose when not in use. This product is designed for use with supervision. Place hose shower head in a safe and secure location when not in use.



AESTHETICS



UNIVERSAL DESIGN



RETROFIT &  
NEW CONSTRUCTION

# BestCare<sup>®</sup>

ADA LIGATURE-RESISTANT  
COLLAPSIBLE HANDHELD SHOWER  
AND MOUNTING BRACKET



- 1. Hand shower socket
- 2. Quick connect shower assembly
- 3. Flex shower hose 1.5 GPM with on/off switch
- 4. Vacuum breaker
- 5. White hand shower assembly
- 6. Swivel connection

\* Optional access box available for containment of hose when not in use. This product is designed for use with supervision. Place hose shower head in a safe and secure location when not in use.



## Whitehall Manufacturing

Manufacturer of Healthcare and Rehabilitation Products since 1946

CONTACT US:

**Phone Number:**

Tel: (800) 782-7706 or (626) 968-6681

Fax: (626) 855-4862

Email: [info@whitehallmfg.com](mailto:info@whitehallmfg.com)

[www.whitehallmfg.com](http://www.whitehallmfg.com)

**Street Address:**

15125 Proctor Avenue

City of Industry, CA 91746 USA

L1001444  
0519



**MORRIS GROUP**  
INTERNATIONAL

[www.morrisgroup.co](http://www.morrisgroup.co)